

## STEP 1 CABLE SETUP



## EASY DEVICE INTEGRATION

### HANDLE CALLS *Works via audio cable*

Take smartphone calls through your headset with the call button.

### MANAGE AUDIO

Hop between receiving PC and device audio through your connected headset.

### TYPE TO DEVICE *Works via Bluetooth*

Quickly switch back and forth between PC and device input typing.

### OPEN / CLOSE SWARM

Hit the Swarm button to quicklaunch the feature-rich Swarm software in an instant.

## WHAT'S ROCCAT® SWARM?



Swarm provides computer to smartphone integration for Skeltr. PC side it offers a software suite and an overview of all your ROCCAT® device settings. Smartphone side it's an extension of the computer software, letting you quicklaunch games, configure illumination options, check your APM, your GPU/CPU temperatures – and more.



## STEP 2 CONNECT YOUR DEVICE

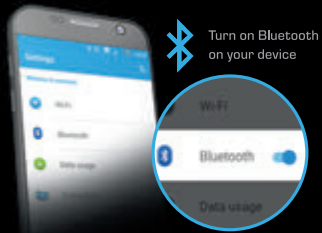

Turn on Bluetooth on your device

Press the button and hold for 2s. The Bluetooth status LED will start flashing and the Skeltr will be visible on your smartphone or tablet as an available Bluetooth device to connect to.



**DE ANLEITUNG**

- Schließe beide USB-Stecker der Skeltr an zwei USB-Anschlüsse Deines PC's an.
- Schließe die Audiokabel der Skeltr an Deinen PC an.
- Starte Deinen Rechner und stelle eine Internetverbindung her.
- Rufe im Browser [www.roccat.org/swarm](http://www.roccat.org/swarm) auf und lade die neueste Swarm-Version herunter.
- Installiere Swarm mithilfe des Installationsprogramms.

**DK INSTRUKTIONER**

- Sæt Skeltr'ens to USB-stik i to ledige USB-porte i pc'en.
- Slut Skeltr'ens lyd kabler til pc'en.
- Tænd computeren, og opret forbindelse til nettet.
- Gå til [www.roccat.org/swarm](http://www.roccat.org/swarm) i browseren, og download den nyeste version af Swarm.
- Installer Swarm ved at følge fremgangsmåden trin for trin.

**EN INSTRUCTIONS**

- Plug the Skeltr's two USB connectors into any two free USB ports on your PC.
- Connect the Skeltr's audio cables to your PC.
- Start your computer and connect to the internet.
- Navigate to [www.roccat.org/swarm](http://www.roccat.org/swarm) in your browser and download the latest version of Swarm.
- Install Swarm by following the installer's step-by-step instructions.

**ES INSTRUCCIONES**

- Enchufa los 2 conectores USB del Skeltr a 2 puertos USB cualesquiera de tu PC.
- Conecta los cables de audio del Skeltr a tu PC.
- Enciende tu equipo y conéctate a Internet.
- Dirigete a [www.roccat.org/swarm](http://www.roccat.org/swarm) en tu navegador y descarga la última versión de Swarm.
- Instala Swarm siguiendo las instrucciones paso a paso del instalador.

**FI OHJEET**

- Liitä Skeltrin kaksi USB-liitäntä PC:n vapaana oleviin USB-portteihin.
- Liitä Skeltrin audiokaapelit PC:hen.
- Käynnistä tietokoneesi ja yhdistä internetiin.
- Mene osoitteeseen [www.roccat.org/swarm](http://www.roccat.org/swarm) ja lataa viimeisin Swarm-ohjelmisto.
- Asenna Swarm-ohjelmisto seuraamalla asennusohjelman ohjeita.

**FR INSTRUCTIONS**

- Branchez les deux connecteurs USB du Skeltr sur deux ports USB libres de votre PC.
- Connectez les câbles audio du Skeltr à votre PC.
- Démarez votre ordinateur et connectez-vous à Internet.
- Rendez-vous sur [www.roccat.org/swarm](http://www.roccat.org/swarm) via votre navigateur, et téléchargez la dernière version de Swarm.
- Installez Swarm en suivant les instructions pas-à-pas du programme d'installation.

**PL INSTRUKCJA**

- Podłącz dwa złącza USB urządzenia Skeltr do dowolnych dwóch gniazd USB w komputerze.
- Podłącz przewód audio urządzenia Skeltr do komputera.
- Włącz komputer i połącz się z internetem.
- Przejdź w przeglądarce na stronę [www.roccat.org/swarm](http://www.roccat.org/swarm) i pobierz najnowszą wersję oprogramowania Swarm.
- Zainstaluj oprogramowanie Swarm, postępując zgodnie ze wskazówkami programu instalacyjnego.

**PT INSTRUÇÕES**

- Liga os dois conectores USB do Skeltr a duas portas USB do teu PC.
- Liga os cabos áudio do Skeltr ao teu PC.
- Inicia o teu computador e liga-te à Internet.
- Vai até [www.roccat.org/swarm](http://www.roccat.org/swarm) no teu navegador e transfere a mais recente versão do Swarm.
- Segue as instruções passo a passo para instalares o Swarm.

**RU ИНСТРУКЦИЯ**

- Подключите два разъема USB Skeltr к любым свободным USB-портам вашего ПК.
- Подключите звуковые кабели Skeltr к ПК.
- Включите компьютер и подключитесь к сети интернет.
- Откройте адрес [www.roccat.org/swarm](http://www.roccat.org/swarm) в вашем браузере и загрузите последнюю версию Swarm.
- Установите Swarm, следуя инструкциям мастера установки.

**SE INSTRUKTIONER**

- Anslut Skeltrns två USB-kontakter till två lediga USB-portar på din dator.
- Anslut Skeltrns ljudkablar till datorn.
- Starta datorn och anslut till den Internet.
- Gå till [www.roccat.org/swarm](http://www.roccat.org/swarm) i webbläsaren och ladda ner den senaste versionen av Swarm.
- Installera Swarm genom att följa installationsprogrammet.